

GENERAL INSTALLATION RECOMMENDATIONS



IMPORTANT!

Thoroughly read these instructions carefully before installing the door.

The manufacturer is not responsible for any damage resulting from improper installation or installation with exposure to weather conditions that exceed the performance rating of the door.

Failure to install the door properly may affect the door's operation, performance and warranty.

PVC GARDEN DOOR



1 TOOLS REQUIRED

- Hammer
- Compatible Exterior grade Sealant
- Shim material
- Level (4' recommended)
- Carpenter's square
- Drill
- Caulking gun
- Phillips head screwdriver
- Measuring tape

2 PRE-INSTALLATION PROCEDURES

- 2.1 Remove tie and other packaging from door.**
CAUTION! The door must always be kept in UPRIGHT POSITION before installing into the wall opening. Make sure the panel door IS LATCHED while proceeding with the door installation.

2.2 PREPARE ROUGH OPENING

- 2.2.1** Make sure that rough opening is properly dimensioned to the door frame size. Rough opening must be $\frac{3}{4}$ " (19 mm) greater than door frame width, and $\frac{1}{2}$ " (12 mm) greater than door frame height.

- 2.2.2** Check framing material. Make sure sill plate is flat, level and straight. Make necessary adjustment.
CAUTION! The sill of the door **MUST BE SUPPORTED** along its entire length or sill deformation **MAY OCCUR!**

- 2.2.3** Check plumb, squareness and dimension of rough opening.
CAUTION! Frame jambs **MUST NOT** in any way bow toward the inside or the outside of the frame.



3 DOOR INSTALLATION PROCEDURES

3.1 LIFT DOOR INTO ROUGH OPENING

- 3.1.1** Apply two $\frac{3}{8}$ " beads of silicone sealant to bottom of rough opening in all areas that will come in contact with the bottom of the door unit. If a nailing flange is used, back caulk the nailing flange.

- 3.1.2** From the exterior, lift and center the door into rough opening.
NOTICE: For nailing flange application, **MAKE SURE** flanges are flush with exterior of rough opening.

NOTICE: If 180° panel operation is desired and the wall thickness is greater than 4-9/16", the INSWING door **must** be installed flush with interior surface and the OUTSWING door **must** be installed 1-3/8" outset from raw opening.



3.2 SHIM DOOR AT LOWER POSITION OF BOTH JAMBS

- 3.2.1** Make sure sill is level.
- 3.2.2** Insert wooden shims between wall framing and lower position of jambs about 6 inches from sill.

- 3.2.3** Install fastener screws of at least 3 inches (75 mm) in length into factory drilled installation holes on lower jambs (or into lower nailing flange if nailing flange is used) to hold the door in place while adjustments are made.



NOTICE: DO NOT tighten screws at this point. Proceed to step 3.5
NOTICE: Shims will prevent bow when unit is fastened to wall framing.

3.3 ADJUST DOOR IN ROUGH OPENING

- 3.3.1** Adjust door in rough opening until the entire unit is plumb, level and square.
(Side, Interior & Exterior)
- 3.3.2** Secure at the upper position of jambs temporarily using wooden shims.
- 3.3.3** Repeat at middle part of jamb. **CAUTION!** FOR CENTER-HINGED DOOR, DO NOT shim behind the strike plate, but a little above or below.
- 3.3.4** Verify the straightness of the head and secure head temporarily using wooden shims.



3.4 CHECK SWING CLEARANCE

Check clearance between the door frame and the panels. The clearance **MUST BE** uniform all the way around. If clearance or swing is not correct, proceed as follows:

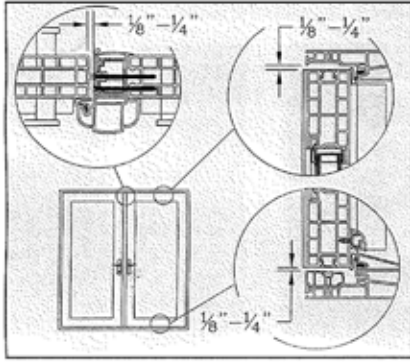

To increase clearance at the bottom of panel (Arrow A), shim at the specified place (Arrow B).
To decrease clearance at the bottom of panel (Arrow A), shim at the specified place (Arrow C).

A) CENTER-HINGED B) FRENCH-HINGED

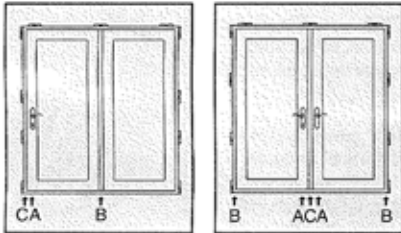

3.5 TIGHTEN FASTENER SCREWS

When the door is well adjusted, and the clearance between door frame and panels is uniform, tighten all fastener screws and plug holes with the supplied hole plug.
CAUTION! Door must remain plumb while tightening fastener screws. Be careful **NOT** to warp the jambs.

3.6 REINFORCING

3.6.1 FOR CENTER-HINGED

Remove screws of center and hook strike plates and replace them with anti-corrosive screws of at least 3 inches (75 mm) in length ensuring to screw right into wall framing. Avoid over tightening screws to prevent possible damage to the strike plate.

NOTICE: Shim should be necessary.

CAUTION! DO NOT shim behind the deadbolt hole or lock mechanism WILL NOT operate properly.

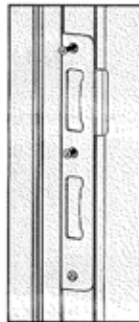

3.6.2 FOR FRENCH-HINGED

Remove 2nd hinge screw from top and replace it with anti-corrosive screw of at least 3 inches (75 mm) in length ensuring that the screw penetrates the wall framing. Repeat for the 6th, 9th and 13th hinge screws. Also repeat for screws of shoot bolt strike plates at head & sill. Avoid over tightening screws to prevent possible damage to the hinge and strike plate.

NOTICE: Shim should be necessary.

NOTICE: DO NOT remove the 1st, 3rd, 5th, 10th, 12th, 14th screws. These are fixed with T-NUTS.

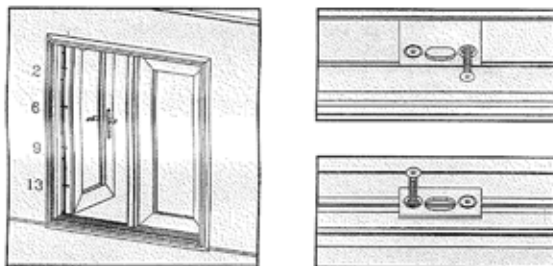

3.7 INSULATE BETWEEN DOOR FRAME AND ROUGH OPENING

Insert insulation on interior side of door between door frame and rough opening.

CAUTION! DO NOT overpack batt insulation. Do not use expandable foam. Bowed jambs may result causing performance problems and/or incorrect operation of door.

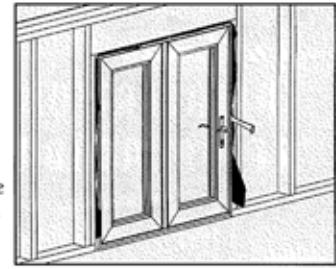

3.8 APPLY SEALANT AROUND EXTERIOR OF THE DOOR

Run a continuous bead of sealant around exterior perimeter of door between frame and exterior finish. If using a surround flange, run a continuous bead of sealant on interior side of the surround flange for installation. **DO NOT** CAULK OVER THE WEEP HOLES.



3.9 PRE-FINISH TRIM (INTERIOR OR EXTERIOR PRE-FINISHING PVC TRIM)

For Inswing door, install supplied pre-finish trim into the groove of interior frame at the head and jambs. For Outswing door, install supplied pre-finish trim into the groove of exterior frame at the head and jambs.

NOTICE: After the installation of French-Hinged Inswing or Outswing door, make sure the finish trim is back set to avoid interference with operation of the hinge. Allow at least 3/8" (9.5 mm) clearance between hinge and finish trim.

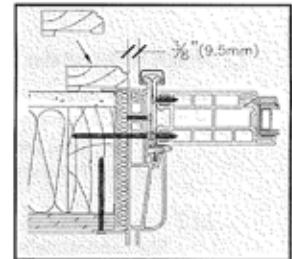
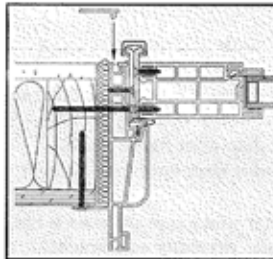

4 HANDLE SET OPERATION

4.1 TO LOCK THE DOOR

- 4.1.1 Activate all of the locking points by turning the handle **upward**.
- 4.1.2 Throw the deadbolt by turning either the key or the knob. The door should now be completely locked.

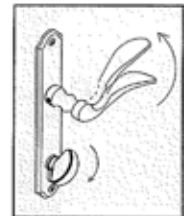

4.2 TO UNLOCK THE DOOR

- 4.2.1 Disengage the deadbolt, by turning either the key or the knob.
- 4.2.2 Deactivate all of the locking points by turning the handle **downward**. The door should now operate normally until locked again.

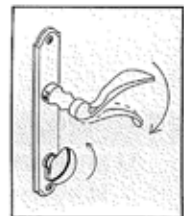

4.3 NORMAL OPERATION OF THE DOOR

For normal operation of the door when unlocked, push handle down to disengage the latchbolt and open the door.

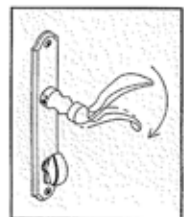

RECOMMENDATION

Ensure that multipoint locking mechanism is engaged whenever door is closed.